

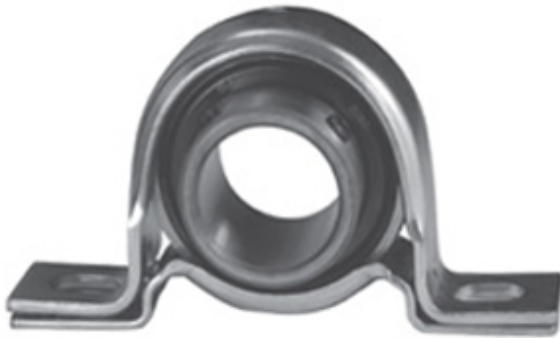

Wuxi LZH Bearing Co., Ltd.

1.25 Inch | 31.75 Millimeter x 1.344 Inch | 34.13
 Millimeter x 1.313 Inch | 33.35 Millimeter LINK
 BELT PSS2E20E Pillow Block Bearings



Bearing No. PSS2E20E

PSS2E20E Bearing 2D drawings and 3D CAD models

Category	Pillow Block Bearings
Inventory	0.0
Manufacturer Name	REXNORD
Minimum Buy Quantity	N/A
Weight	0.504
EAN	0662864017916
Product Group	M06110
Number of Mounting Holes	2
Mounting Method	Set Screw
Housing Style	2 Bolt Pillow Block
Rolling Element	Ball Bearing
Housing Material	Stamped Steel
Expansion / Non-expansion	Non-expansion
Mounting Bolts	3/8 Inch
Relubricatable	No
Insert Part Number	MB251-14S-PA
Seals	Single Lip Contact
Housing Configuration	1 Piece Solid
Inch - Metric	Inch
Other Features	Single Row Standard Duty Has Flinger
Long Description	2 Bolt Pillow Block; 1-1/4" Bore; 1-5/16" Base to Center Height; Set Screw Mount; Ball Bearing; 3-9/16" Minimum Bolt Spacing;



Wuxi LZH Bearing Co., Ltd.

	3-15/16" Bolt Spacing Maximum; No Relubricatable; Stam
Category	Pillow Block
UNSPSC	31171511
Harmonized Tariff Code	8483.20.40.40
Noun	Bearing
Keyword String	Pillow Block
Manufacturer URL	http://www.rexnord.com
Manufacturer Item Number	PS251-14S
Manufacturer Internal Number	5805575
Weight / LBS	1.11
Nominal Bolt Center to Center	3.8 Inch 97 Millimeter
B	1.313 Inch 33.35 Millimeter
Bolt Spacing Minimum	3.563 Inch 90.5Millimeter
d	1.25 Inch 31.75 Millimeter
Bolt Spacing Maximum	3.938 Inch 100.025Millimeter
D	1.344 Inch 34.13 Millimeter
Actual Bolt Center to Center	0 Inch 0Millimeter